

Add-on options

Perfusion/Media exchange system

For marketed 35mm dishes, allows exchange media without removing dish lid. (prevents media evaporation and contamination during long-term imaging)

Model
KSX-Type 1 (for STX/STR series)
KS-Type 1 (for INU series)

Components:
LX-D35FME/D35-200FME, KS-DIA
KS-PUMPx2, KS-BOTTLE
Pump flow rate: 0.27 - 3.8ml
Pump size: W168xD120xH115
Silicon tube: outer dimension 3.0mm
* Media waster bottle is not included.

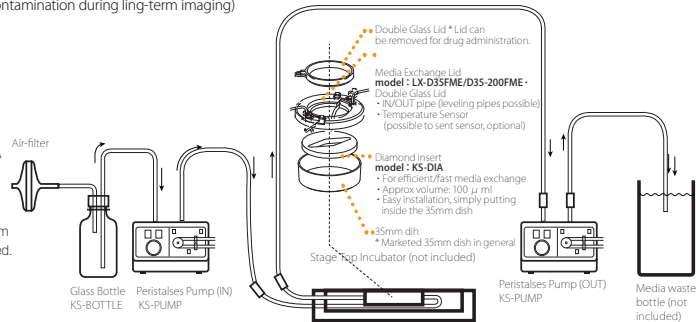

One Push Drug Delivery system

Rapid and vibration-free drug administration possible. Drug administration without allows removing dish lid. (prevents media evaporation and contamination during long-term imaging)

Model
KSX-Type 2 (for STX/STR series)
KS-Type 2 (for INU series)

Specification
Dosage: 20-100µl
(contact us if different dosage is needed)
Controller: W168 x D120 x H115mm
Silicon tube: outer dimension 3.0mm

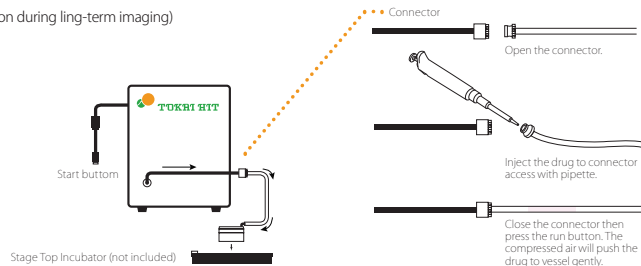

Media Leakage Detector

Detect the media leakage and stop the media pump to prevent damage to microscope.

Model
LM-UNIV2-D35
LM-UNIV-D35

Controller:
Shuts down electricity as soon as it detects leakage.
Sensored Dish Attachment:
Place it inside the chamber unit.

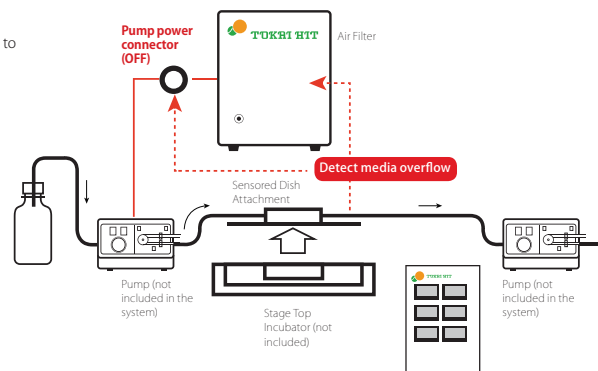

Digital Thermometer for research

Digital thermometer with fine sensor : The system is calibrated as a set to obtain an accurate temp. measurement.



Digital Thermometer

Model : **MC1000**
(K type thermocouple)
Indicates Temp. by 1 degree C / 0.1 degree C units

Content includes:
· Digital thermometer
· Thermo probe
(Model: TSU-200F)

Thermo probe

Model : **TSU-200F**
Sensor probe which has high chemical resistant and prevents heat transfer of measured object.

Extension cable (1.5m)
model : **HD-1500** (optimal for MC1000)
Width of tip: 2.5mm / Tip thickness: 0.5mm



Magnet Fixing Block

For open dish media exchange and drug administration use (e.g. upright microscope)



Dish Attachment for Media Exchange / Drug delivery Magnet Fixing Block

Model:
PSBD1 Pipe OD1.1(mm)
PSBD1H Pipe OD1.1(mm) / ID0.8(mm)
PSBD2 Pipe OD2.1(mm)
PSBD2H Pipe OD2.1(mm) / ID1.0(mm)



Exclusive Dish Attachment for PSBD1H/2H
Model :
KS-(Chamber name)
-D35

Exclusive spacers for Greiner, IWAKI, and Nunc 35mm dishes

recommend to equip at the bottom of the dish

Above brand vessels has cut-out at the bottom. From the cut-out, humidity, CO₂ and temperature will be leaking out from chamber unit and may build the condensation on the objective.



Spacer for Iwaki
Model : **35DI-BS**



Spacer for Greiner and Nunc
Model : **35DGN-BS**

Injection Access Port (for INU series)

Modified solution access ports on the Top Heater allows drug administration without opening the Top Heater.



Model : **H2** (dual ports)
Model : **H1R** (one part on right)
Model : **H1L** (one part on left)
※ We can correspond to various custom orders